

REV.	DESCRIPTION	ECN NO.	NAME	DATE
1	NEW FRAME	N/A	LDH	2020-7-2

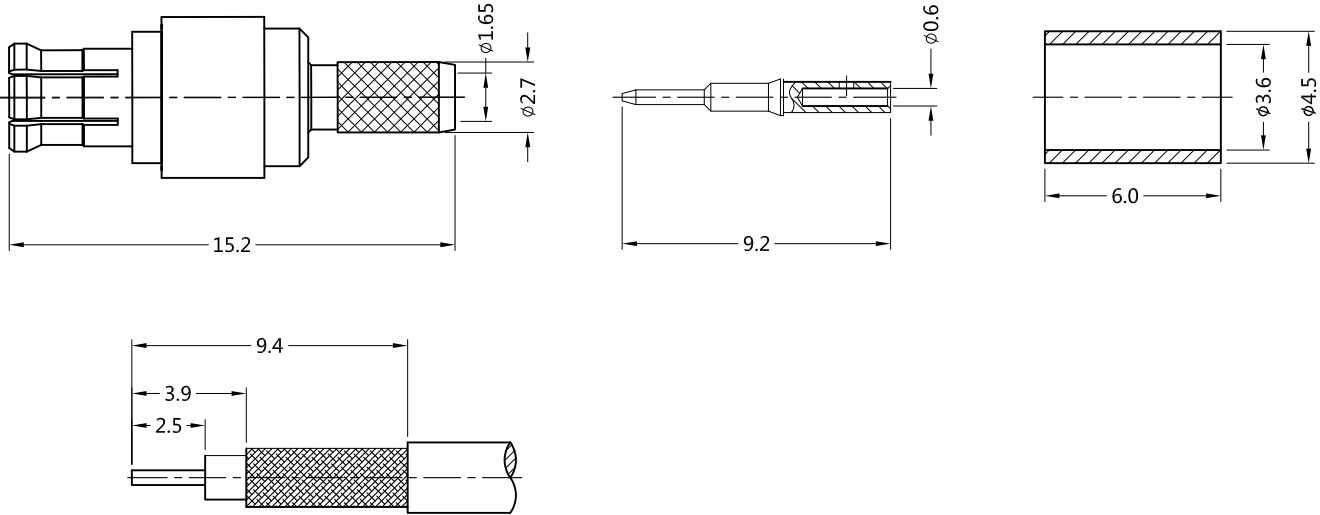

ALL PARTS MUST MEET TO RoHS REQUIREMENTS

1. CRIMPED FERRULE
HEX. CRIMP SIZE .130"
2. CRIMPED PIN TO SOLDER



RECOMMENDED
CABLE STRIPPING DIM'S

MATERIALS AND PLATING		UNIT: MICRO-INCHES
PART NAME	MATERIALS	PLATING
OUTER CONTACT	BERYLLIUM COPPER	ALBALOY 200~300u" /COPPER
CONTACT PIN	BRASS	COPPER/NICKEL/GOLD 10u"
INSULATOR	TEFLON MIL-P-19468	N/A
BODY	BRASS	ALBALOY 200~300u" /COPPER

ELECTRICAL CHARACTERISTICS	
IMPEDANCE	50 Ω
VOLTAGE RATING	335 VRMS MAX
FREQUENCY RANGE	0 ~ 6 GHz
DIELECTRIC WITHSTANDING VOLTAGE	>500 V RMS MIN
INSULATION RESISTANCE	>1000 MΩ
INSERTION LOSS	ACCORDING TO THE CABLE
VSWR	<1.3
RF- LEAKAGE	N/A

MECHANICAL CHARACTERISTICS	
ENGAGEMENT FORCE	<5.6 LBS
SEPARATION FORCE	>1.8 LBS
CENTER CONTACT RETENTION FORCE	>1.8 LBS(AFTER ASSEMBLY)
DURABILITY	> 500 cycles

ENVIRONMENTAL PARAMETER	
TEMPERATURE RANGE	-40 °C~+85 °C

* CUSTOMER OUTLINE DRAWING

UNLESS OTHERWISE SPECIFIED:

- 1) EDGES : C0.15 MAX ;
- 2) REMOVE ALL BURRS ;
- 3) SURFACE ROUGHNESS : Ra1.6 ;
- 4) UNITS : mm ;
- 5) DIMENSIONS TOLERANCES
DECIMALS : .x ±0.3 .xx ±0.2 .xxx±0.1;
ANGLES : ± 5°.

THIRD ANGLE PROJECTION

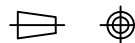

APPROVED :

CUSTOMER P/N :

CHECKED :

SCALE :

4 : 1

DRAWING :

LDH

DATE : 2020-7-2

PAGE : 1/1



TITLE : MCX MALE S/T CRIMP FOR
RG-316 D CABLE,50Ω

DRAWING NO. :
5MXM11S-A50-004

COMPANY WEBSITE : www.slkcorp.com

CUSTOMER OUTLINE DRAWING